



NEW AGE SUB SURFACE
DEWATERING SYSTEM

Installation Manual

MANUFACTURED BY



REX POLYEXTRUSION

MARKETED BY



Streamline System Products

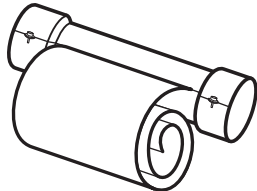

STREAMLINE BELT+COUPLER ASSEMBLY

200 mm wide Belt attached to
200 mm x 65 mm special coupler

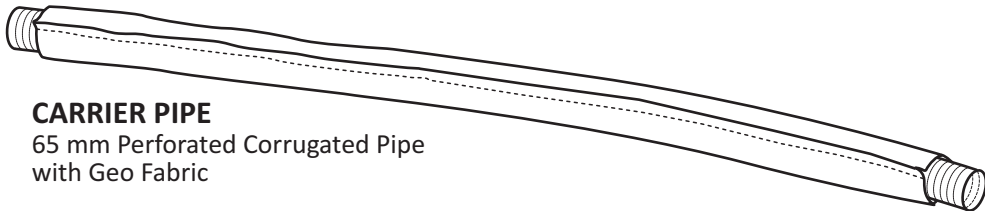

CARRIER PIPE

65 mm Perforated Corrugated Pipe
with Geo Fabric

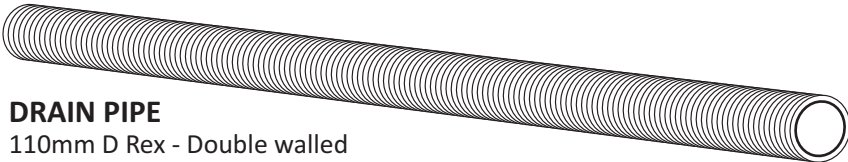

DRAIN PIPE

110mm D Rex - Double walled
Corrugated Pipe

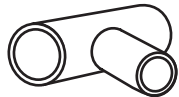

T-JUNCTIONS



L-JUNCTIONS



END CAPS

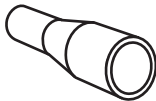

REDUCERS

ACCESSORIES

Filler Materials

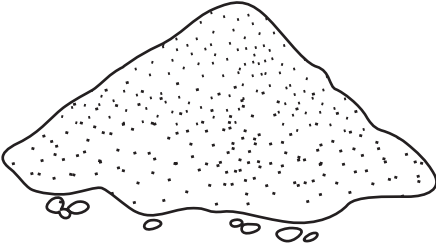

Fine Sand

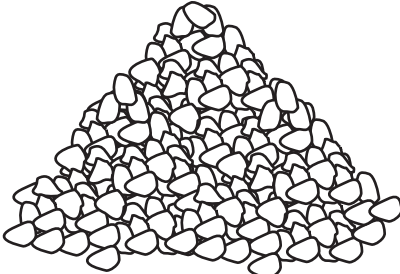

Gravel (5mm to 10mm)

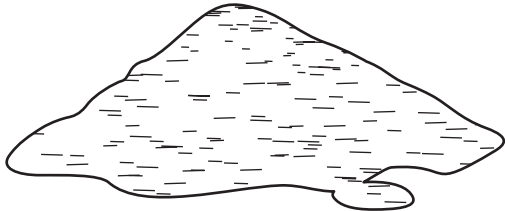

Backfilling Medium as desired

1

Preparation before installing 'Streamline'

Clean the area to be installed - no sharp objects or material greater than 10mm in size should be allowed.



SHARP OBJECTS



MORE THAN 10mm

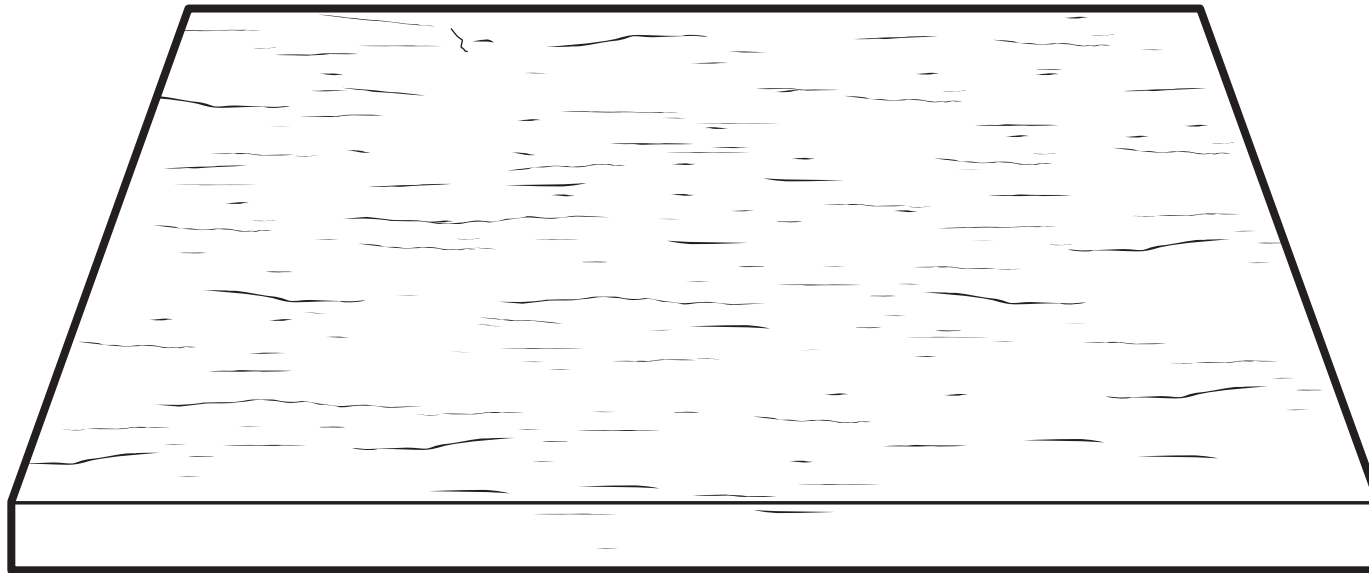

2

Preparation before installing 'Streamline'

Make the trenches to lay the pipes of the system as per the layout given in the drawing. Compact the sub base.

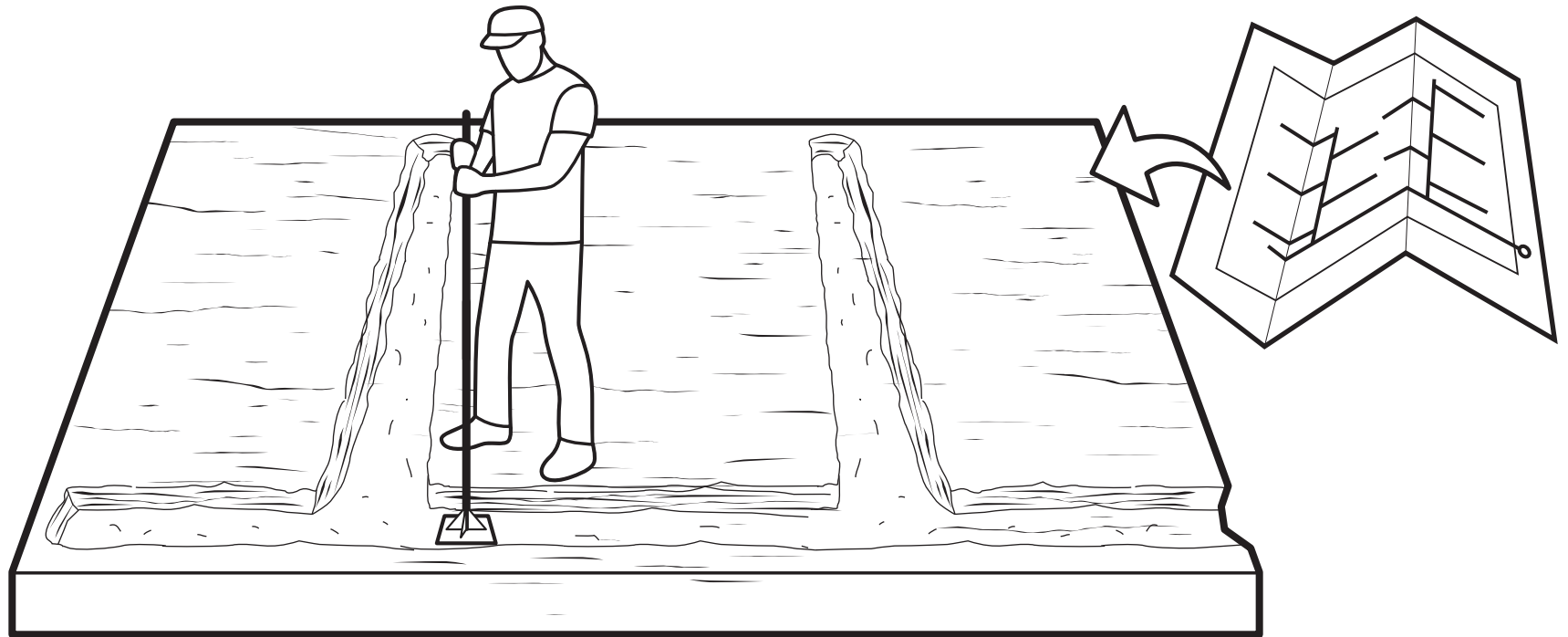

3

Preparation before installing 'Streamline'

Create a base of 10mm Gravel for the trenches

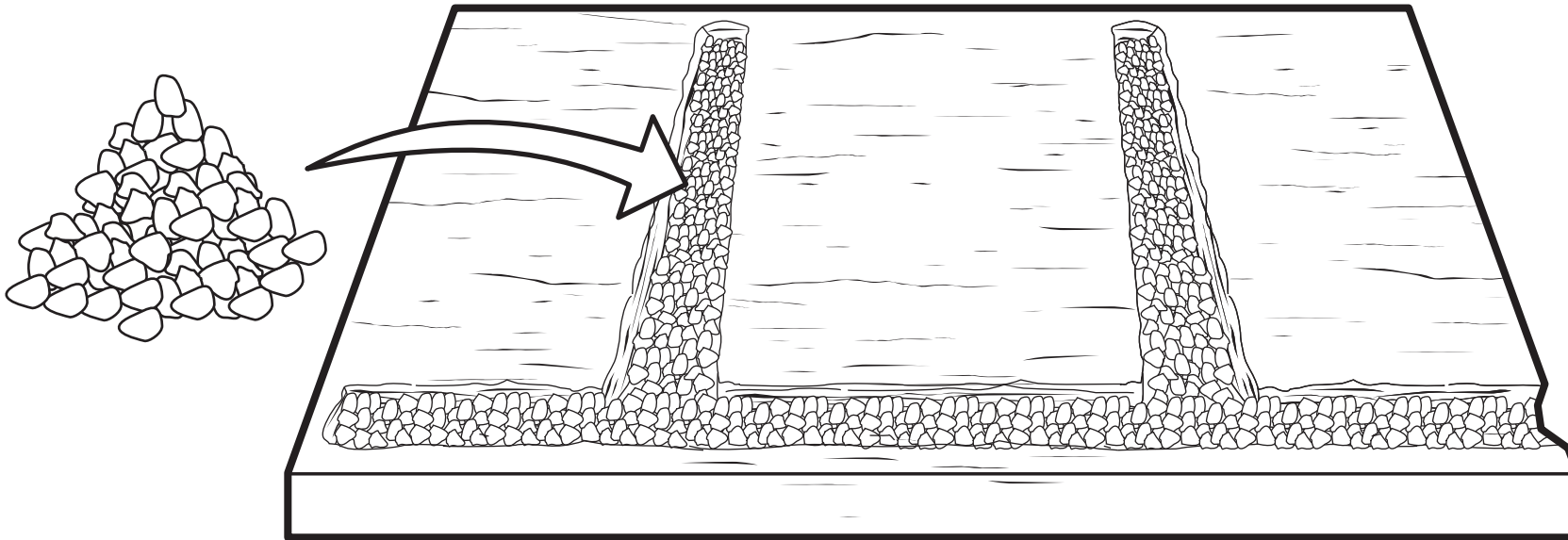

4

Preparation before installing 'Streamline'

Maintain a slope of minimum 0.2% with the gravel. 0.2% is mandatory for a rapid flow - if possible give a greater gradient to get faster water movement.

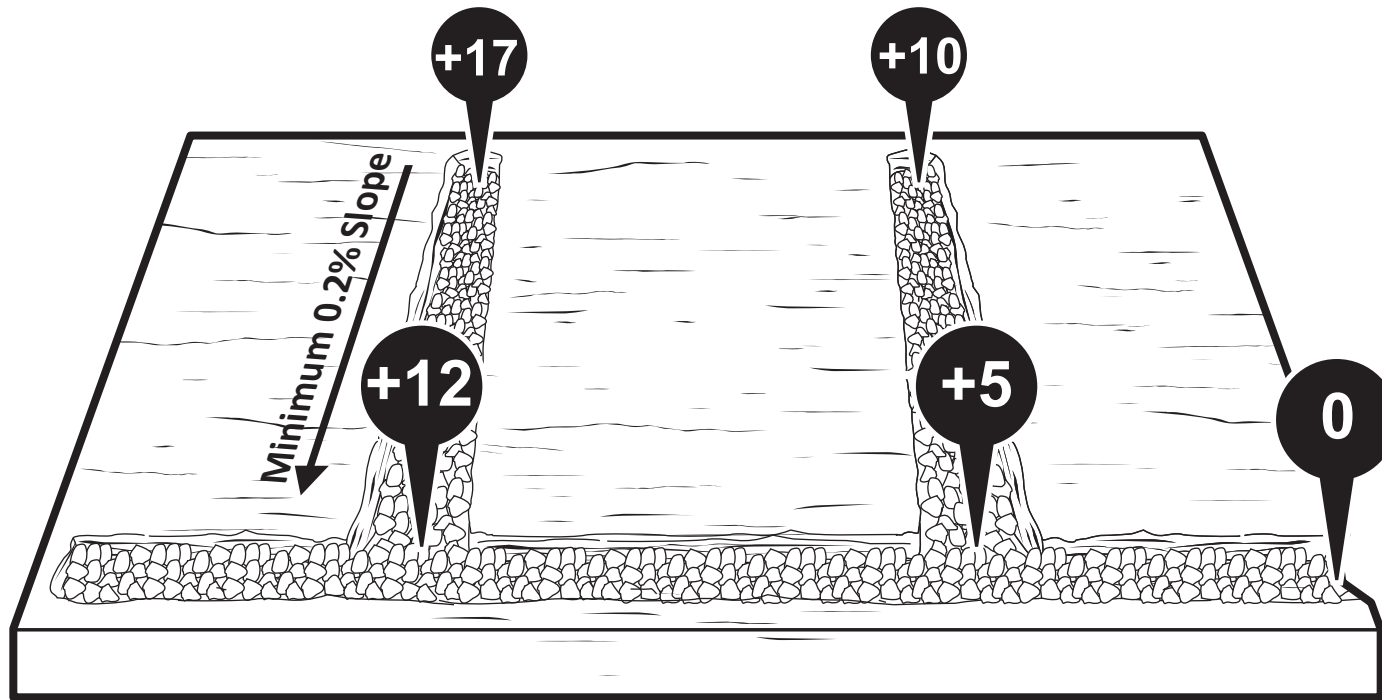

5

Installation of 'Streamline system'

Drain Pipe Assembly - Prepare the Drain Pipe by cutting and attaching the required accessories as per the drawing.

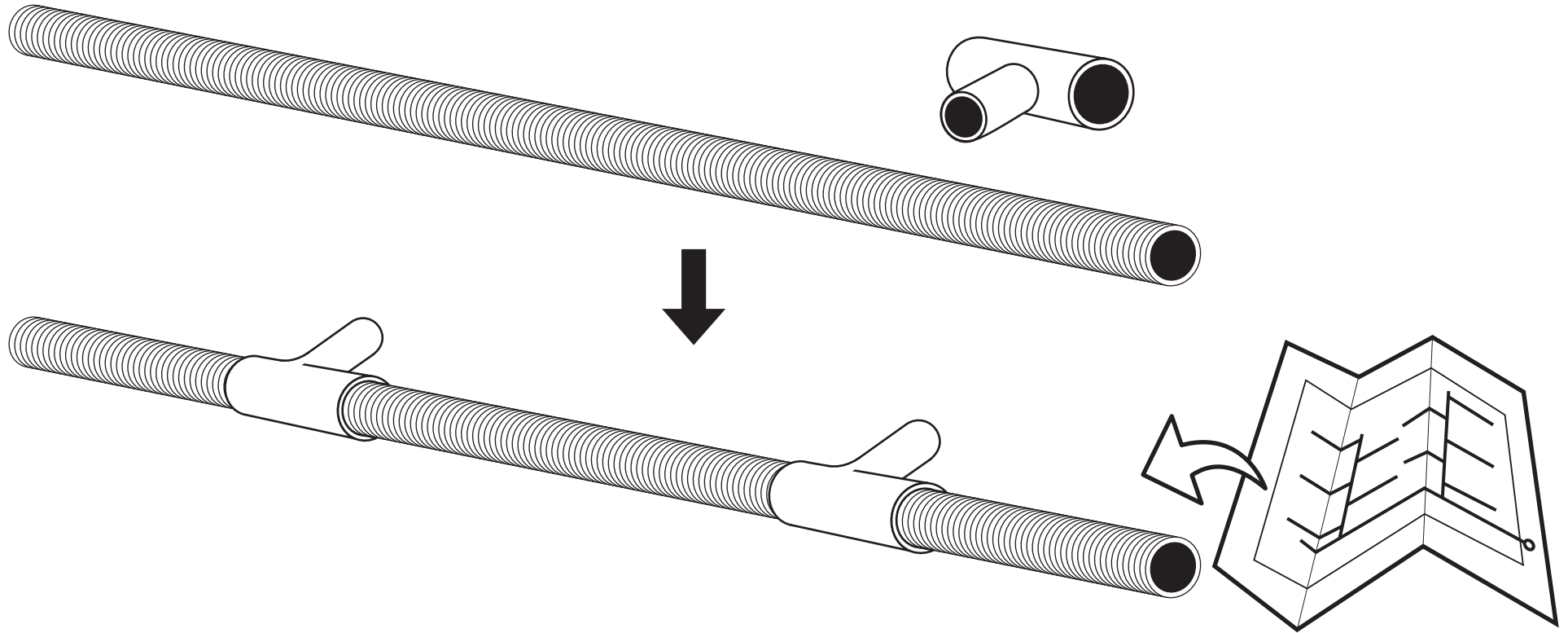

6

Installation of 'Streamline system'

Lay the prepared **Drain Pipe Assembly** in place as per drawing

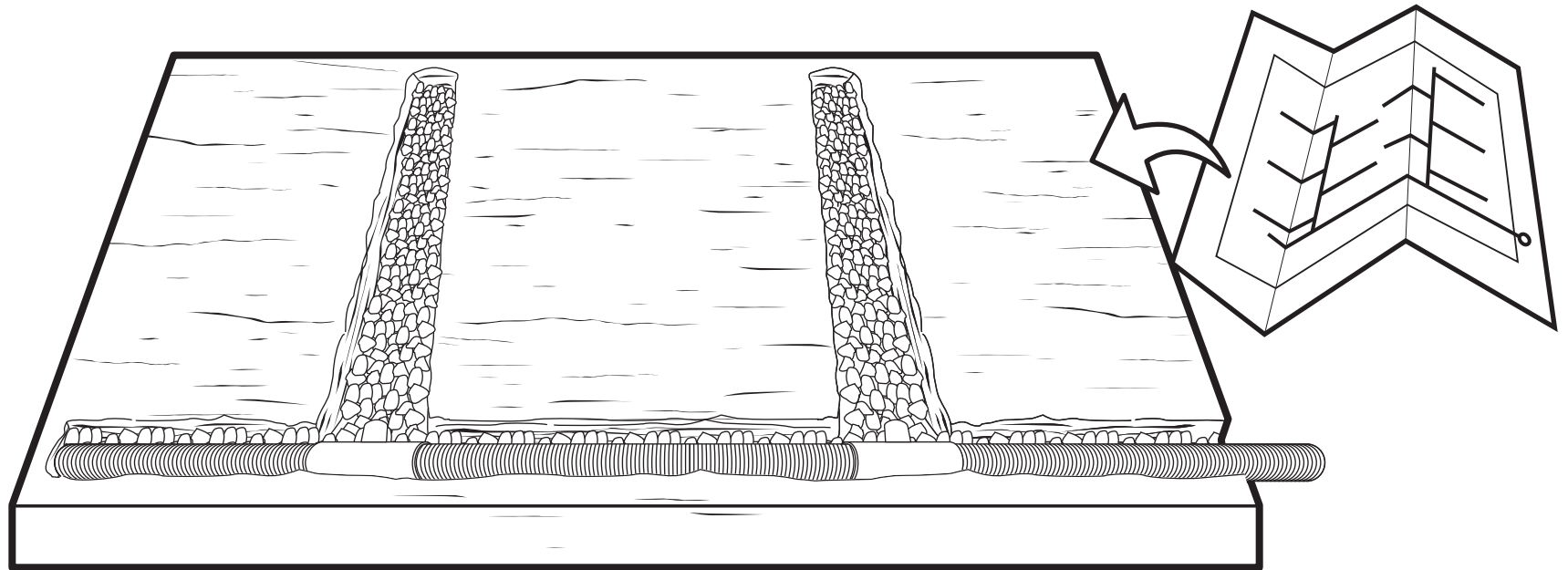

7a Installation of 'Streamline system'

Belt Assembly - Open and straighten the Perforated Corrugated Pipe

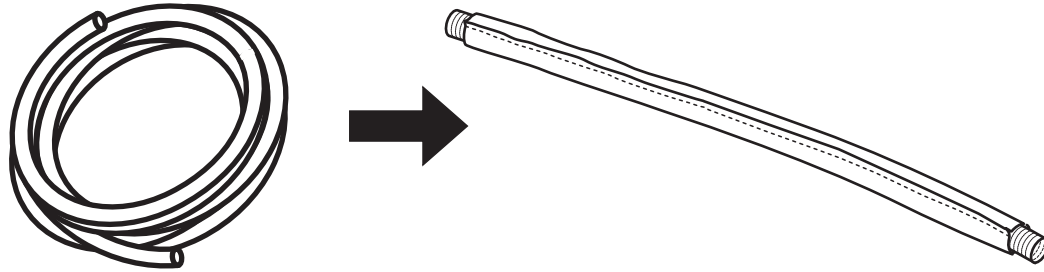

7a Belt Assembly - Cut the Perforated Corrugated Pipe as per drawing

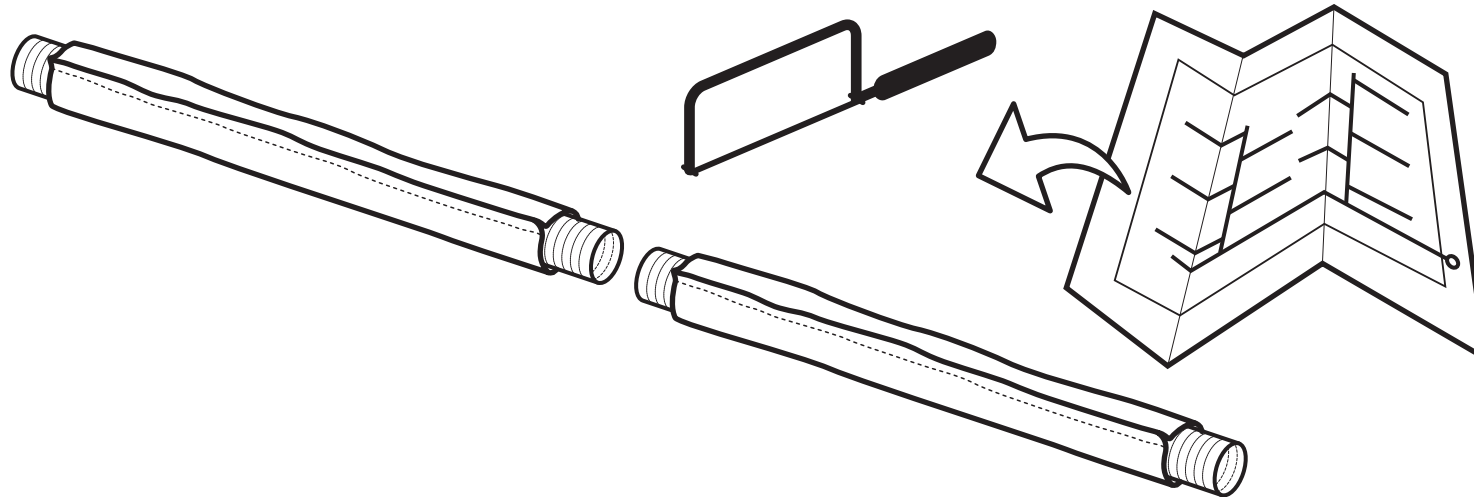

8

Installation of 'Streamline system'

Belt Assembly - Join Belt+Coupler Assembly with Perforated Corrugated Pipe by solvent cement as per drawing

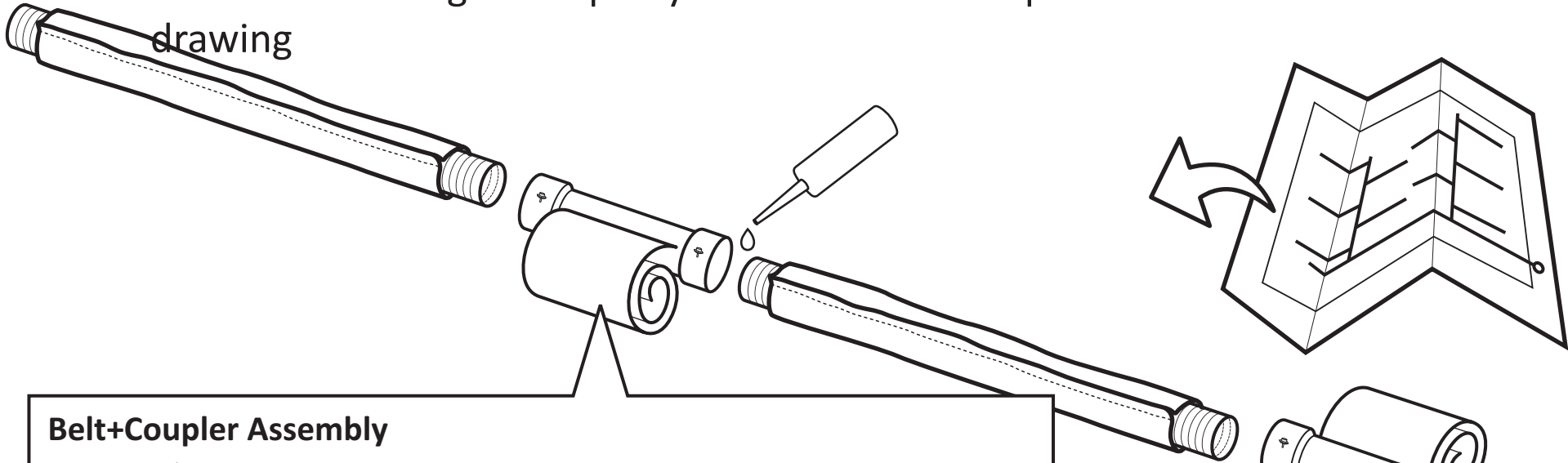

Belt+Coupler Assembly



Always place the coupler with the belt junction at 45 degrees facing upwards



The Belt should always be placed with grooves facing down and smooth side facing up.

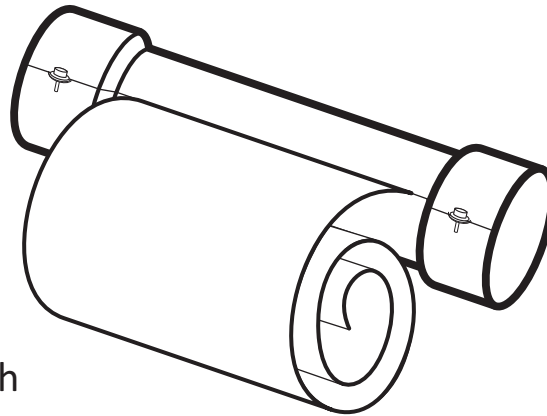

9

Installation of 'Streamline system'

Place the Belt Assembly in the trench as per drawing and join to the Carrier Pipe Assembly with Solvent Cement

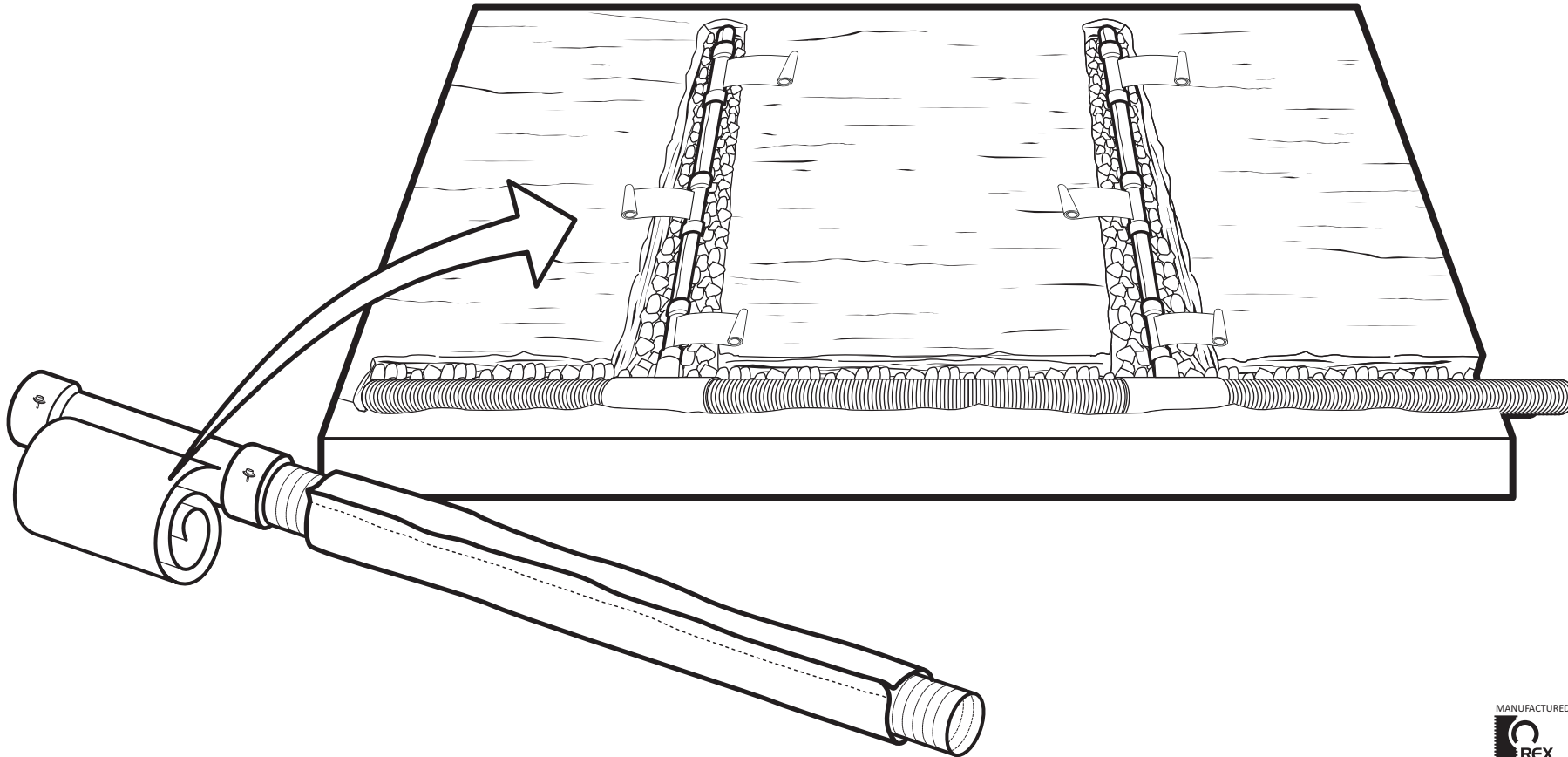

10 Installation of 'Streamline system'

Open the curled belts and put sand below them just to ensure a minimum gradient of 0.2% and to enhance the capillary action

1:200 SLOPE

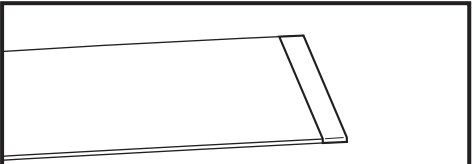

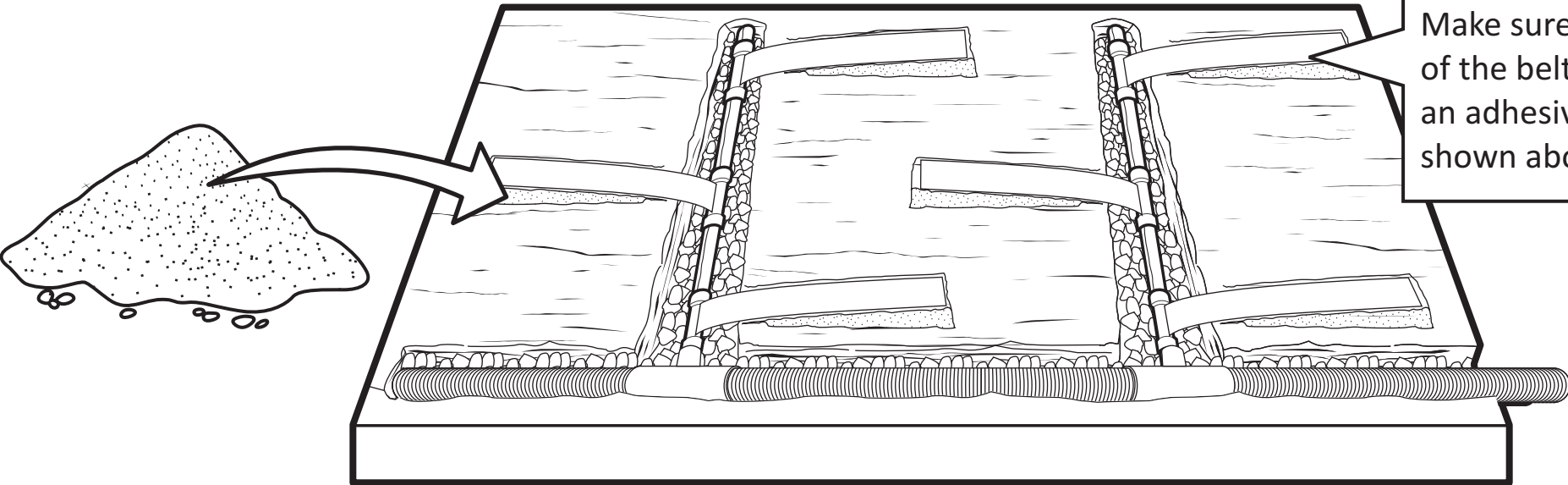
Make sure the open end of the belt is sealed with an adhesive tape as shown above



11

Installation of 'Streamline system'

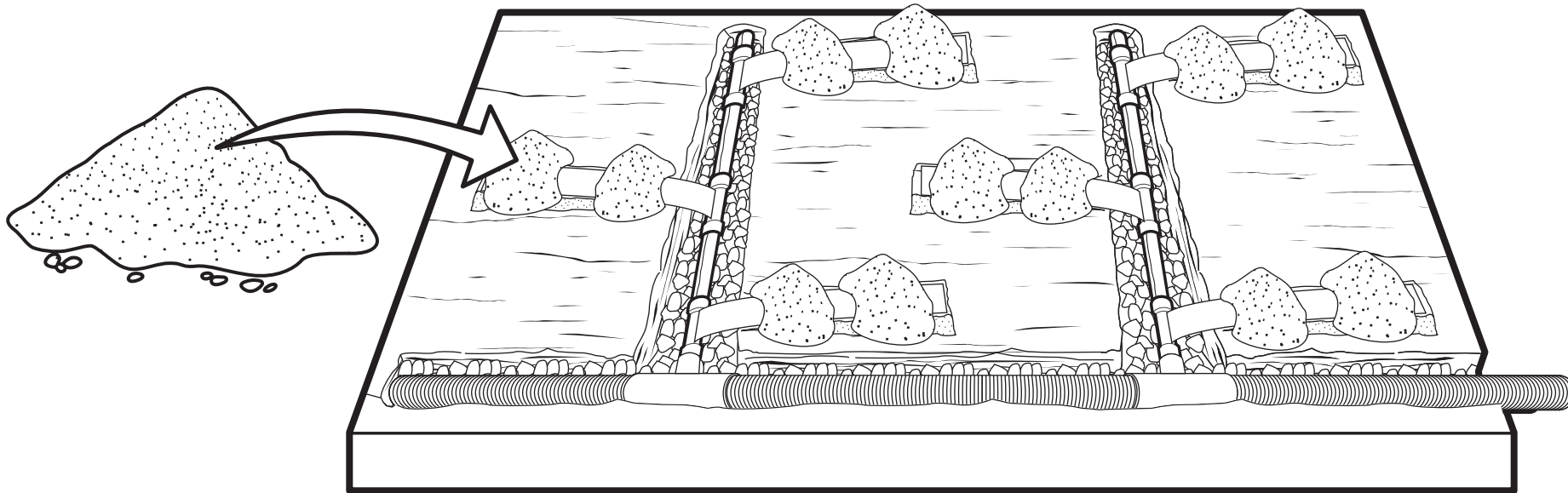
Put sand over the belts to ensure they maintain position



12

Installation of 'Streamline system'

Backfill the Corrugated Pipes and Carrier Pipes with 10 mm Gravel/Aggregate area to the 6" level as per your design

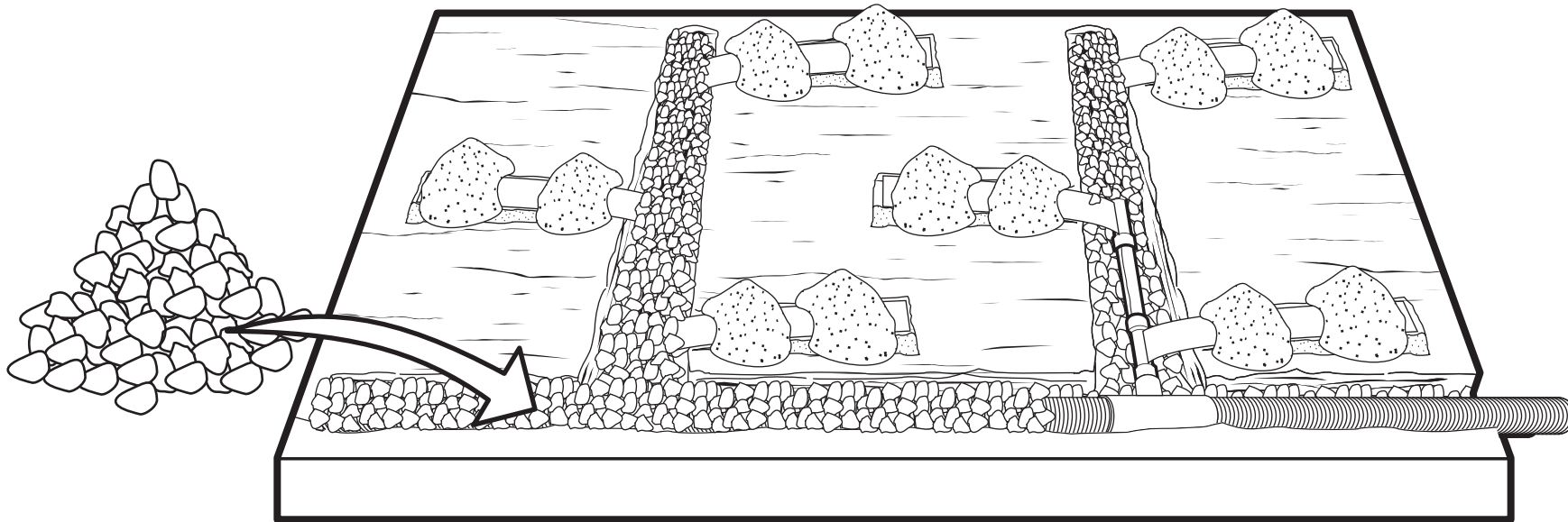

13 Installation of 'Streamline system'

Backfill the whole area with desired soil substrate to the level as per your design.

